



Nepco Park Enclosed Shelter

Enclosed Shelter

1410 Griffith Ave., Wisconsin Rapids, WI

Meetings * Weddings * Graduations * Birthdays * Celebrations * Memorials



Available Year—Round

CAPACITY = 250 PEOPLE

Seats 150 comfortably

Sat. & Sun. or any full day: 8am-Midnight

M-F 1/2 day: 8am-4pm or 4-Midnight

Holiday Rate: 8am-Midnight

Partial days must be reserved by calling the office.

Visit our website for pricing information

Noise absorbing panels

Furnace and A/C

Kitchen area with sink

Refrigerator (no freezer) (17 cubic foot)

Microwave (No Oven/Stove)

Accessible restrooms, Ceramic tile floors

Serving counter with sink/Bar

200+ folding chairs

20 – 60" round tables, 12 – 6' banquet tables

40'x60' reception area (8'x16' bar area)

Coat racks, Large charcoal grill

Near playground, beach, hiking trail & boat landing

WIFI is now available through Solarus. Simply turn on

WIFI on your smartphone and follow the instructions.



POPU-



MAY 23 2006

MAKE YOUR RESERVATION NOW!

<https://parksreservations.woodcountywi.gov/parks/>

715-421-8422 / parks@woodcountywi.gov

For more information, see "Shelter Policies & Fees" at

<https://www.woodcountywi.gov/Departments/Parks/>

or CHECK US OUT ON FACEBOOK!

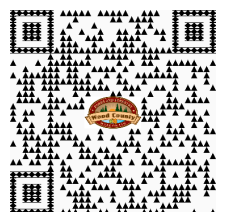





NEPCO SHELTER

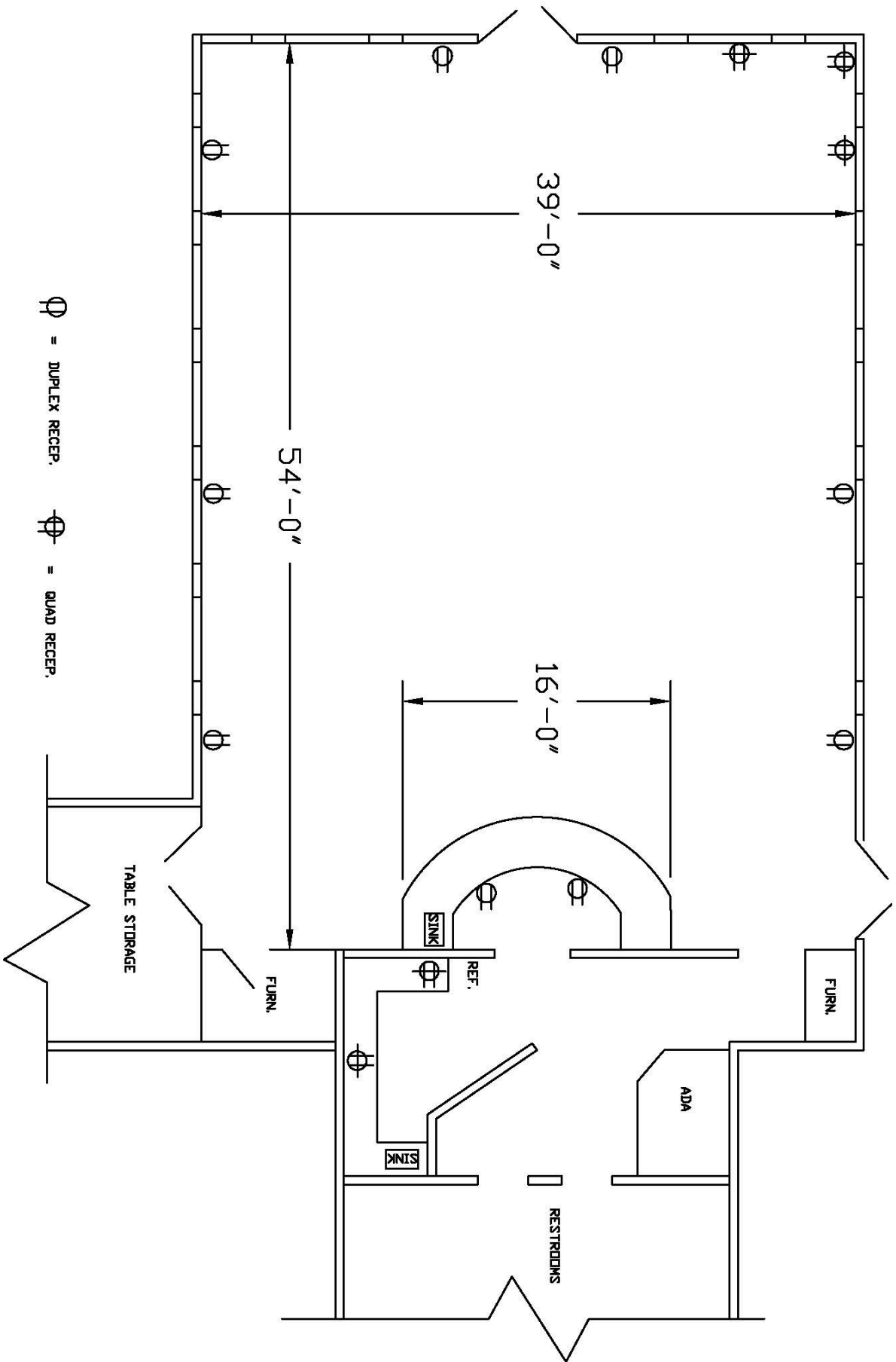

Scale
1/8"=1'

Note: If above scale doesn't measure 1" in length, then drawing scale is incorrect.

NEPCO PARK ENCLOSED SHELTER

Cleaning check list

Basic cleaning supplies are located in the kitchen which includes broom, wipes and garbage bags.

	Remove all decorations, tape and eye hooks from walls, ceilings, tables, windows. No confetti or helium balloons allowed.
	Wipe spills from counters, microwave, refrigerator, and floors
	Sweep floor
	Replace tables and chairs back in to frames in storage room
	Place garbage and recyclables from inside and outside of shelter in to the appropriate containers in the parking lot. Replace Bags
	Extinguish fire in the grill
	Take all food and personal items with you
	Turn water faucets off
	Close all windows and doors
	Turn off lights and lock the door (Bathroom lights automatically turn off EXCEPT in handicap bathroom)

***FAILURE TO COMPLY WITH THE ABOVE WILL SUBJECT THE USER TO BE BILLED FOR THE COST OF LABOR AND/OR REPAIRS**

Please let us know if you have any questions, concerns or comments by sending us an email to parks@woodcountywi.gov.

Would you like to reserve this shelter again? You may do so up to ONE YEAR in advance.

Scan the QR code to be taken directly to the reservation system.

<https://parksreservations.woodcountywi.gov/parks/>

