



# South Park—Open Shelter

Located at 6921 South Park Road  
Wisconsin Rapids WI 54494

**Meetings \* Weddings \* Graduations \* Birthdays\* Celebrations \* Memorials**

**Available Friday before Memorial Day  
through Labor Day ONLY!**

This shelter is also available at NO CHARGE on a first-come, first-served basis if not reserved. No access to indoor spaces without reservations.

**10am—10pm Daily**

**Holiday Rates**

***No partial day reservations.***

***Please visit our website for current pricing***

**Seats 130 comfortably (10/table)**

**(13) 8' Picnic tables**

**Shelter is 45' x 63'**

Flush Restrooms, sink and refrigerator  
available inside enclosed shelter when rented

**3'x12' Serving counter with 3 outlets**

**4 sets of additional electrical outlets**

**Charcoal grill**

**Playground**

**Sand volleyball court**

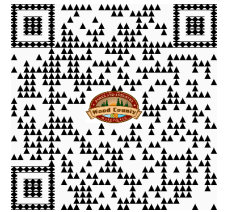

**MAKE YOUR RESERVATION NOW!**

**<https://parksreservations.woodcountywi.gov/parks/>**

**715-421-8422 / [parks@woodcountywi.gov](mailto:parks@woodcountywi.gov)**

**For more information, see “Shelter Policies & Fees” at  
<https://www.woodcountywi.gov/Departments/Parks/>**

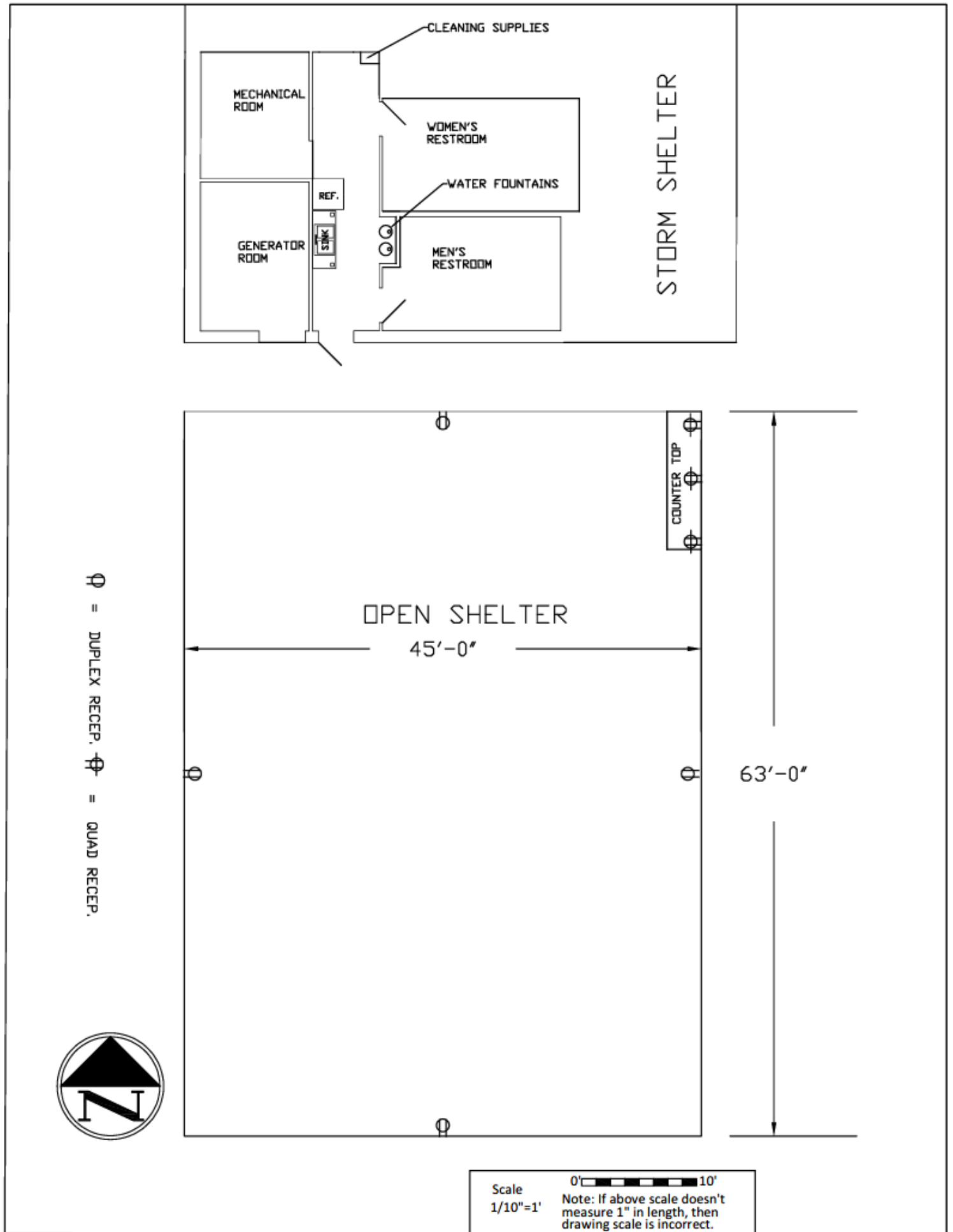

# SOUTH PARK OPEN SHELTER

## Cleaning Checklist

*Basic cleaning supplies are in the hallway which includes broom, wipes and garbage bags.*

	Remove all decorations, tape and confetti
	Wipe all tables, counters, and seats
	Take all food and personal items with you
	Move all tables back to original positions
	Extinguish fire in grill
	Place garbage and recyclables from inside/outside the shelter into the appropriate containers in the parking lot. Replace bags <b>*Plastic bags are not allowed in the recycling container. Dump contents directly into recycling container and place the plastic bag into garbage container.</b>
	Turn off all outside lights. Lights inside the Storm Shelter will shut off automatically
	Close and relock all push bar doors. Ensure other doors are closed securely as these will <i>automatically lock at the end of the reservation.</i>

**\*FAILURE TO COMPLY WITH THE ABOVE WILL SUBJECT THE USER TO BE BILLED FOR THE COST OF LABOR AND/OR REPAIRS**

Please let us know if you have any questions, concerns or comments by sending us an email to [parks@woodcountywi.gov](mailto:parks@woodcountywi.gov).

**Would you like to reserve this shelter again? You may do so up to ONE YEAR in advance. Scan the QR code to be taken directly to the reservation system.**

**<https://parksreservations.woodcountywi.gov/parks/>**

