



Red Sands Stone Enclosed Shelter
South Wood County Park
Located at 7111 South Park Road
Wisconsin Rapids WI 54494

Meetings * Weddings * Graduations * Birthdays * Celebrations * Memorials



Available May 1 — October 15

CAPACITY = 250 PEOPLE

Seats 150 comfortably (10/table)

Sat. & Sun. or any full day: 8am-Midnight

M-F 1/2 day: 8am-4pm or 4-Midnight

Holiday Rate: 8am-Midnight

Partial days must be reserved by calling the office.

Visit our website for pricing information

Shelter is 45'-6" x 63'

(16) 8' Picnic Tables

1 Refrigerator

**Utility sink, Microwave & Fireplace inset
(does not provide enough heat to warm shelter)**

Electrical outlets (24) – 8/west wall,

4/north wall, 4/south wall 8/on counter

Accessible Restrooms, Large Charcoal Grill

Two (2) sets of horseshoe pits



Find us on:
facebook®

MAKE YOUR RESERVATION TODAY

<https://parksreservations.woodcountywi.gov/parks/>

715-421-8422 / parks@woodcountywi.gov

For more information, see "Shelter Policies & Fees" at

<https://www.woodcountywi.gov/Departments/Parks/>

or CHECK US OUT ON FACEBOOK!

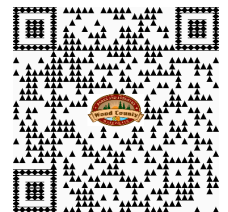

SOUTH-PARK SHELTER

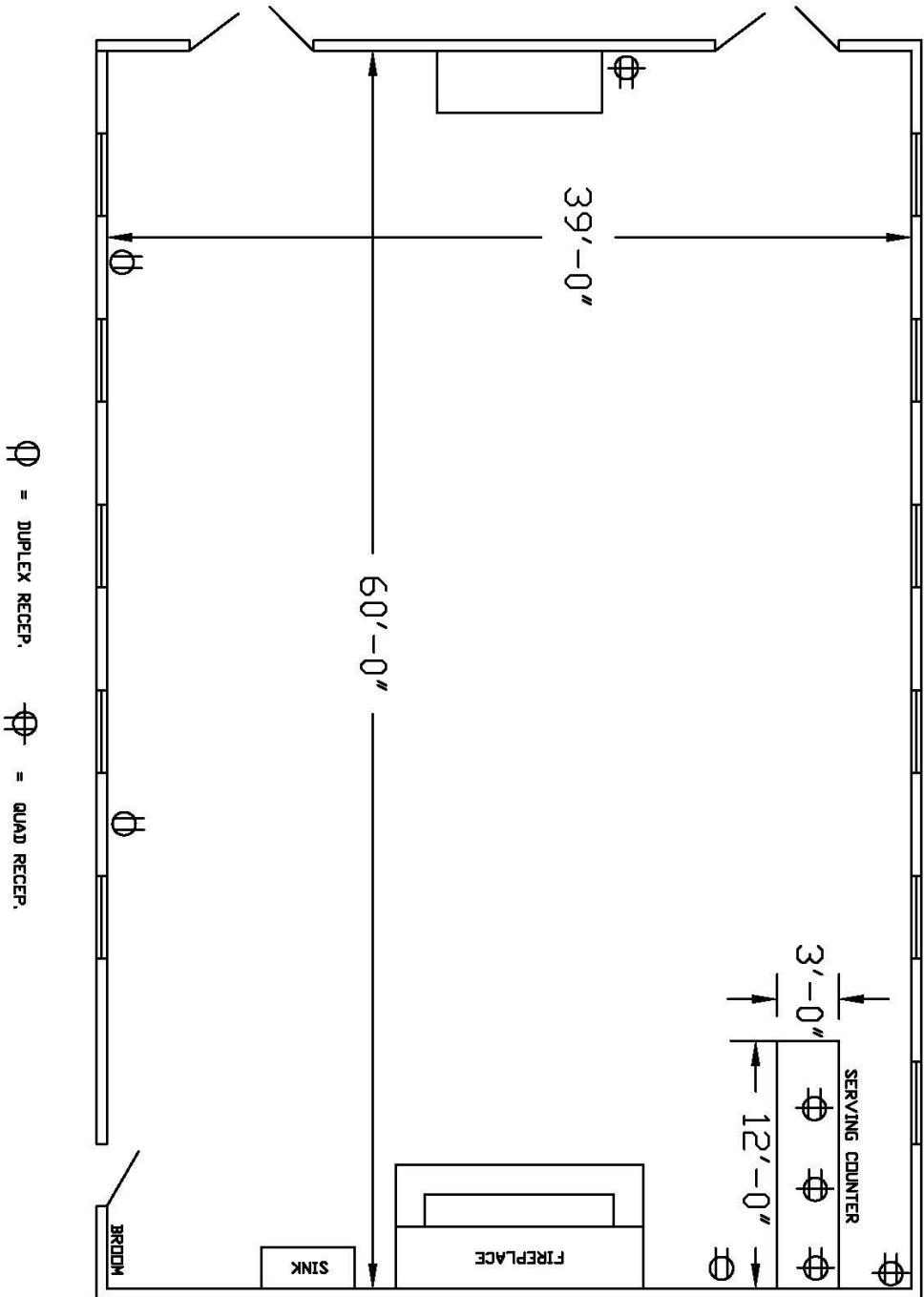

Scale
1/8"=1'
0' 8'
Note: If above scale doesn't
measure 1" in length, then
drawing scale is incorrect.

RED SANDS STONE ENCLOSED SHELTER

Cleaning check list

Basic cleaning supplies are located in the kitchen which includes broom, wipes and garbage bags.

DO NOT USE THE FIREPLACE ON THE NORTH WALL

	Remove all decorations, tape and confetti from walls, ceilings, tables, windows
	Wipe spills from counters, microwave, refrigerator, and floors
	Sweep floor
	Replace tables and chairs back to original location—picnic tables from inside the
	Place garbage and recyclables from inside and outside of shelter in to the appropriate containers in the parking lot. Replace Bags
	Extinguish fire in the grill and fireplace.
	Take all food and personal items with you
	Turn water faucets off
	Close and lock all windows and doors including the bathrooms
	Turn off lights and lock the door

*FAILURE TO COMPLY WITH THE ABOVE WILL SUBJECT THE USER TO BE BILLED FOR THE COST OF LABOR AND/OR REPAIRS

Please let us know if you have any questions, concerns or comments by sending us an email to parks@woodcountyiwi.gov.

Would you like to reserve this shelter again? You may do so up to

<https://parksreservations.woodcountyiwi.gov/parks/>

