



# Nepco Lake County Park

## Enclosed Shelter

1410 Griffith Ave., Wisconsin Rapids, WI

**Meetings \* Weddings \* Graduations \* Birthdays \* Celebrations \* Memorials**



### Available Year—Round

CAPACITY = 250 PEOPLE

Seats 150 comfortably

M-F for 8 hours: 8am-4pm or 4pm—Midnight—\$250

*Partial day reservations must be made by calling the office.*

Weekends/FULL DAYS 8am—Midnight— Daily Rate—\$300

Holiday Rate: \$350/day

Noise absorbing panels installed in 2017

Furnace and A/C

Kitchen area with sink

Refrigerator (no freezer) (17 cubic foot)

Microwave (No Oven/Stove)

Accessible restrooms, Ceramic tile floors

Serving counter with sink/Bar

200+ folding chairs

20 – 60” round tables, 12 – 6’ banquet tables

40’x60’ reception area (8’x16’ bar area)

Coat racks, Large charcoal grill

Near playground, beach, hiking trail & boat landing

WIFI is now available through Solarus. Simply turn on WIFI on your smartphone and follow the instructions.



**POPULAR FOR WEDDINGS!**

**MAKE YOUR RESERVATION NOW!**

**<https://parksreservations.woodcountywi.gov/parks/>  
715-421-8422 / [parks@woodcountywi.gov](mailto:parks@woodcountywi.gov)**

**For more information, see “Shelter Policies & Fees” at  
<https://www.woodcountywi.gov/Departments/Parks/>  
or CHECK US OUT ON FACEBOOK!**

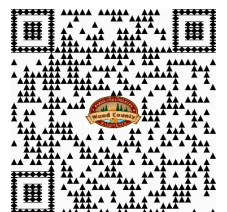





# NEPCO SHELTER

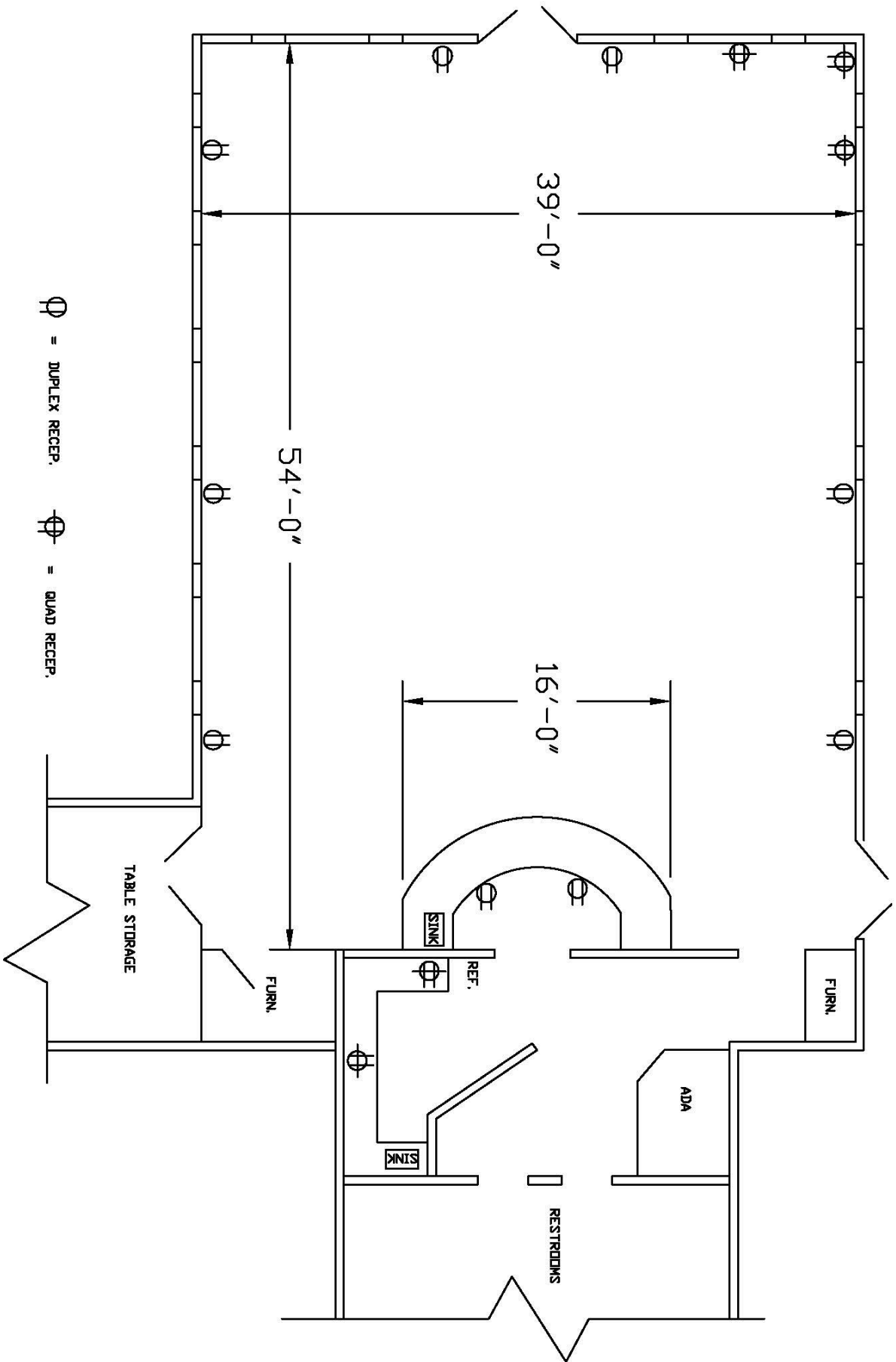

⊕ = DUPLEX RECEPT.    ⊕ = QUAD RECEPT.

Scale  
1/8"=1'

Note: If above scale doesn't measure 1" in length, then drawing scale is incorrect.

# NEPCO SHELTER Cleaning check list

*Basic cleaning supplies are located in the kitchen which includes broom, wipes and garbage bags.*

	Remove all decorations, tape and confetti from walls, ceilings, tables, windows and eye hooks
	Wipe spills from counters, microwave, refrigerator, and floors
	Sweep floor
	Replace tables and chairs back in to frames in storage room
	Place garbage and recyclables from inside and outside of shelter in to the appropriate containers in the parking lot. Replace Bags
	Extinguish fire in the grill
	Take all food and personal items with you
	Turn water faucets off
	Close all windows and doors
	Turn off lights and lock the door (Bathroom lights automatically turn off EXCEPT in handicap bathroom)

**\*FAILURE TO COMPLY WITH THE ABOVE WILL SUBJECT THE USER TO BE BILLED FOR THE COST OF LABOR AND/OR REPAIRS**

Please let us know if you have any questions, concerns or comments by sending us an email to [parks@woodcountywi.gov](mailto:parks@woodcountywi.gov).

**Would you like to reserve this shelter again? You may do so up to ONE YEAR in advance.**

**Scan the QR code to be taken directly to the reservation system.**

**<https://parksreservations.woodcountywi.gov/parks/>**

