



South Park Community Shelter

Located at 6923 South Park Road

Wisconsin Rapids WI 54494

Meetings * Weddings * Graduations * Birthdays * Celebrations * Memorials

Available year round EXCEPT the Friday before Memorial Day through Labor Day

(used only for emergency storm shelter in the summer)

Capacity=99 people

Seats 70 comfortably

Weekends/Full Days 10am-10pm

M-F Partial day: 10am-4pm or 4pm-10pm

Partial day reservations must be made by calling the office.

See website for current pricing

Main gathering space is 48'x30'

Includes the use of the adjacent open shelter

5- 8' banquet tables, 10- 6' round tables, 70 folding chairs

Furnace and A/C

11x11 Kitchen area with sink, refrigerator (no freezer), microwave (no stove).

Additional refrigerator and sink available

Flush restrooms

WIFI

Playground, walking trail, volleyball and beach nearby

**This shelter is first and foremost a storm shelter. In the event a severe weather event/emergency occurs during your event (Severe Thunderstorm Warning, Tornado Watch, Tornado Warning), the storm shelter becomes available to the public for emergency shelter.*



MAKE YOUR RESEVATION NOW!

<https://parksreservations.woodcountywi.gov/parks/>

715-421-8422 / parks@woodcountywi.gov

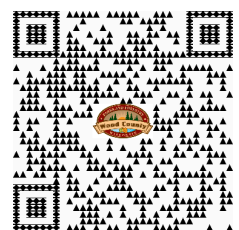

STORM SHELTER

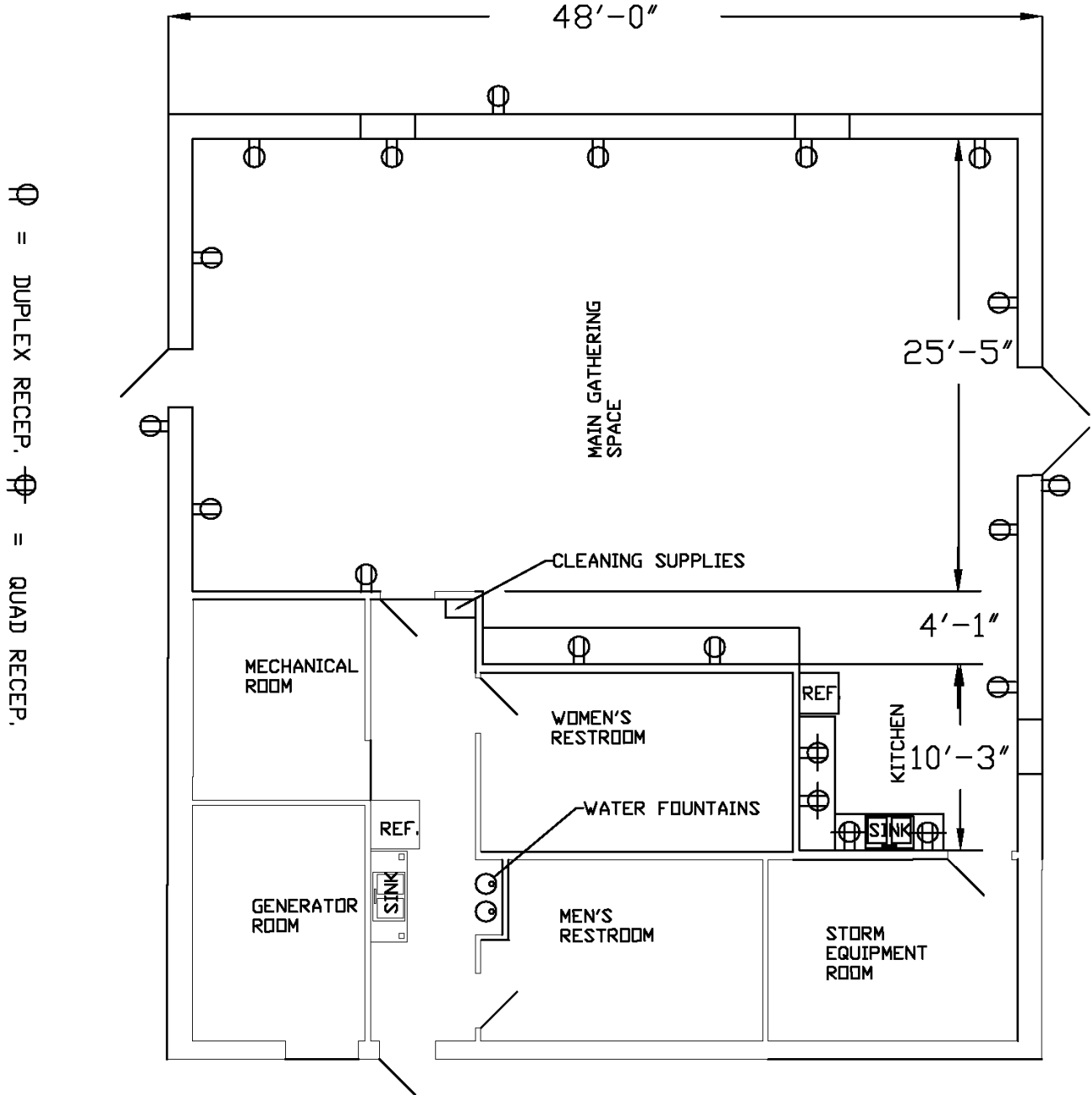

OPEN SHELTER 45'X63'

Scale
1/8"=1'

0' 8'

Note: If above scale doesn't
measure 1" in length, then
drawing scale is incorrect.

COUNTER TOP

SOUTH PARK COMMUNITY SHELTER

Cleaning Checklist

Basic cleaning supplies are in the hallway which includes broom, wipes and garbage bags.

	Remove all decorations, tape and confetti from walls, ceilings, tables No decorations allowed on the windows!
	Wipe spills from counters, microwave, refrigerator and floors
	Sweep Floors
	Replace all tables and chairs to their original location
	Place garbage and recyclables from inside/outside the shelter into the appropriate containers in the parking lot. Replace bags *Plastic bags are not allowed in the recycling container. Dump contents directly into recycling container and place the plastic bag into garbage container.
	Take all food and personal items with you
	Close and relock all push bar doors. Ensure other doors are closed securely, as these will <i>automatically lock at the end of the reservation.</i>
	Lights will shut off automatically

***FAILURE TO COMPLY WITH THE ABOVE WILL SUBJECT THE USER TO BE BILLED FOR THE COST OF LABOR AND/OR REPAIRS**

Please let us know if you have any questions, concerns or comments by sending us an email to parks@woodcountywi.gov.

Would you like to reserve this shelter again? You may do so up to ONE YEAR in advance. Scan the QR code to be taken directly to the reservation system.

<https://parksreservations.woodcountywi.gov/parks/>





South Park—Open Shelter

Located at 6921 South Park Road
Wisconsin Rapids WI 54494

Meetings * Weddings * Graduations * Birthdays* Celebrations * Memorials

**Available Friday before Memorial Day
through Labor Day ONLY!**

This shelter is also available at NO CHARGE on a first-come, first-served basis if not reserved. No access to indoor spaces without reservations.

10am—10pm Daily

Holiday Rates

No partial day reservations.

Please visit our website for current pricing

Seats 130 comfortably (10/table)

(13) 8' Picnic tables

Shelter is 45' x 63'

Flush Restrooms, sink and refrigerator
available inside enclosed shelter when rented

3'x12' Serving counter with 3 outlets

4 sets of additional electrical outlets

Charcoal grill

Playground

Sand volleyball court

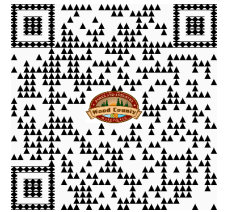

MAKE YOUR RESERVATION NOW!

<https://parksreservations.woodcountywi.gov/parks/>

715-421-8422 / parks@woodcountywi.gov

**For more information, see “Shelter Policies & Fees” at
<https://www.woodcountywi.gov/Departments/Parks/>**

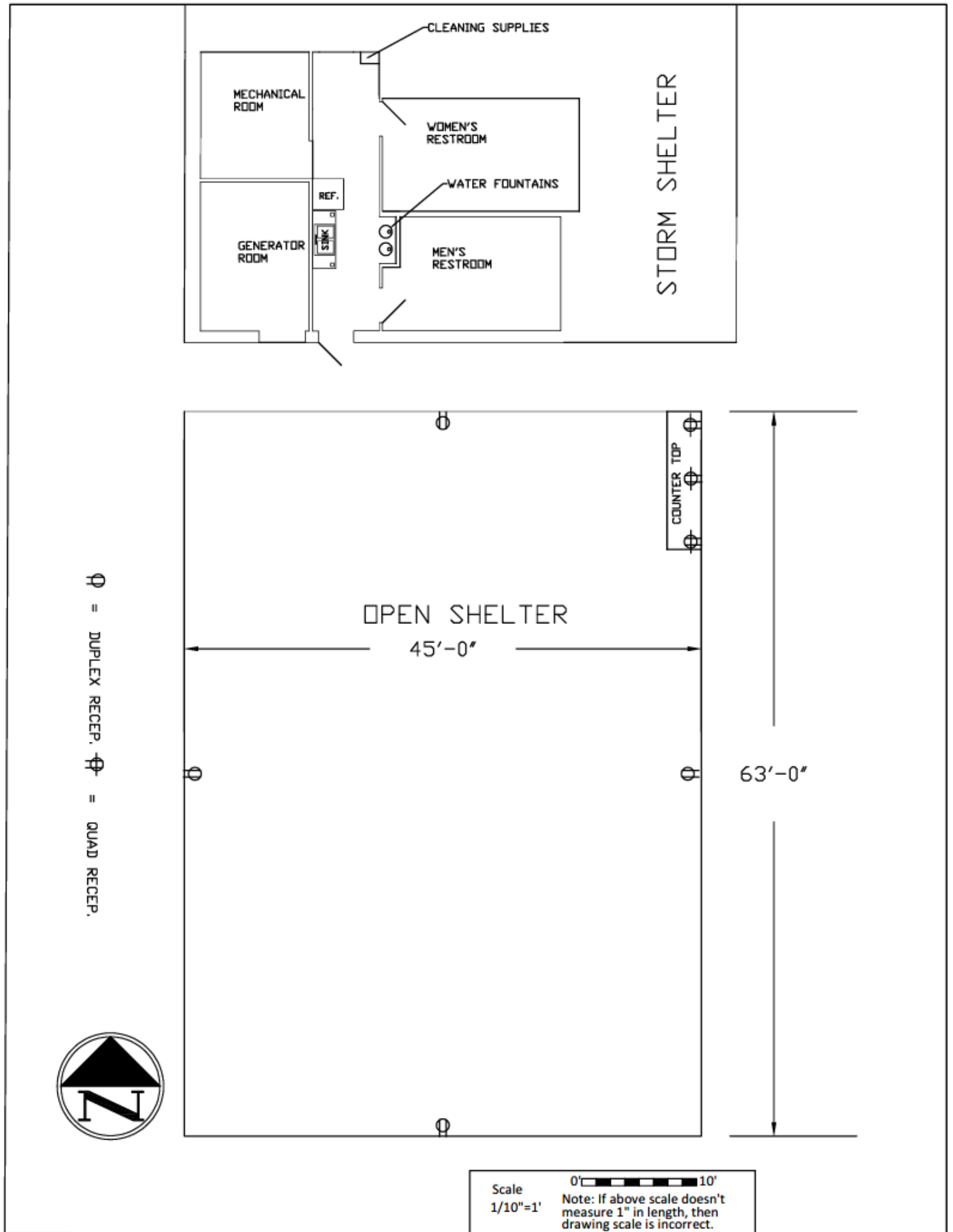

SOUTH PARK OPEN SHELTER

Cleaning Checklist

Basic cleaning supplies are in the hallway which includes broom, wipes and garbage bags.

	Remove all decorations, tape and confetti
	Wipe all tables, counters, and seats
	Take all food and personal items with you
	Move all tables back to original positions
	Extinguish fire in grill
	Place garbage and recyclables from inside/outside the shelter into the appropriate containers in the parking lot. Replace bags *Plastic bags are not allowed in the recycling container. Dump contents directly into recycling container and place the plastic bag into garbage container.
	Turn off all outside lights. Lights inside the Storm Shelter will shut off automatically
	Close and relock all push bar doors. Ensure other doors are closed securely as these will <i>automatically lock at the end of the reservation.</i>

***FAILURE TO COMPLY WITH THE ABOVE WILL SUBJECT THE USER TO BE BILLED FOR THE COST OF LABOR AND/OR REPAIRS**

Please let us know if you have any questions, concerns or comments by sending us an email to parks@woodcountywi.gov.

Would you like to reserve this shelter again? You may do so up to ONE YEAR in advance. Scan the QR code to be taken directly to the reservation system.

<https://parksreservations.woodcountywi.gov/parks/>

